



# 2010

34<sup>th</sup> Annual

---

## Pacific Circle Consortium Conference

*Transformative Education: From Vision to Action*

May 4-7, 2010

Southern Oregon University  
Ashland, Oregon, USA

Thank you for your interest in the 34th Annual Pacific Circle Consortium Conference. The conference is hosted by the School of Education at Southern Oregon University in Ashland, Oregon, USA. We are excited to have you visit our beautiful campus, situated in the lovely Rogue Valley in Southern Oregon.

This year's conference will explore

Social Justice

Teacher Education

Innovative Approaches,  
Ideas, and Policies



# Table of Contents

Conference Overview . . . . .	2
Letters of Welcome . . . . .	4
The Pacific Circle Consortium . . . . .	6
Southern Oregon University . . . . .	7
Office of International Programs . . . . .	7
Confucius Classroom at St. Mary’s School . . . . .	8
Daily Shuttle Bus . . . . .	9
Conference Accommodations . . . . .	10
Ashland Dining . . . . .	11
Electronic Conference Proceedings . . . . .	12
The Pacific-Asian Education Journal . . . . .	12
Daily Schedule: Tuesday, May 4 . . . . .	13
Daily Schedule: Wednesday, May 5 . . . . .	14
Wednesday Invited Speakers . . . . .	15
Wednesday Morning Presentations, 11:00 – 12:30 . . . . .	16
Wednesday Afternoon Presentations, 1:45 – 3:15 . . . . .	17
Daily Schedule: Thursday, May 6. . . . .	18
Thursday Invited Speakers . . . . .	19
Thursday Morning Presentations, 10:30 – 12:00 . . . . .	20
Thursday Afternoon Presentations, 1:30 – 3:00 . . . . .	21
Daily Schedule: Friday, May 7 . . . . .	22
Friday Invited Speakers . . . . .	23
Friday Morning Presentations, 10:30 – 12:00 . . . . .	24
Friday Afternoon Roundtable Discussions, 1:00 – 1:55 . . . . .	25
Friday Afternoon Poster Presentations, 2:00 – 2:45 . . . . .	26
The Peter Brice Award . . . . .	27
The Arthur R. King Jr. Award for Curriculum Innovation . . . . .	28
Conference Maps . . . . .	29
Southern Oregon University. . . . .	29
Stevenson Union Building . . . . .	30
Hannon Library Building. . . . .	31
Ashland City Map . . . . .	32
Conference Evaluation Form . . . . .	33

# Conference Overview

Tuesday, May 4

12:00 – 2:15	<i>Visits to local schools Shuttle bus pickup from/return to hotels, drop off at Stevenson Union</i>	
2:30	<i>Executive Council shuttle bus pickup from hotels, drop off at Stevenson Union</i>	
3:00 – 6:00	Executive Council Meeting	Guanajuato Room (Stevenson Union, 315)
4:00 – 8:00	Conference Registration	Thorndike Art Gallery (Art Building)
6:00 – 6:45	<i>Shuttle Bus Service: pickup from hotels, drop off at Art Building</i>	
7:00 – 9:00	Opening Reception	Thorndike Art Gallery (Art Building)
8:30 – 9:30	<i>Shuttle Bus Service: return to hotels</i>	

Wednesday, May 5

7:00 – 8:00	<i>Morning Shuttle Bus Service: pickup from hotels, drop off at Art Building</i>	
8:00 – 12:00	Conference Registration	Thorndike Art Gallery (Art Building)
8:00 – 9:30	Conference Welcoming & Recognition of Country	Meese Auditorium (Art Building)
9:30 – 10:30	Invited Speakers Plenary Session	Meese Auditorium (Art Building)
11:00 – 12:30	Paper Panel Sessions	Stevenson Union Building
12:30 – 1:30	Lunch (provided)	
	International participants	Hannon Library, 305 (Meese Room)
	US participants	Guanajuato Room (Stevenson Union, 315)
1:45 – 3:15	Paper Panel Sessions	Stevenson Union Building
3:30 – 4:00	Impressions of the Day	Hannon Library, 305 (Meese Room)
4:15 – 5:45	General Assembly meeting	Hannon Library, 305 (Meese Room)
4:00 – 6:00	<i>Afternoon Shuttle Bus Service: pickup from Hannon Library, return to hotels</i>	
6:00 – 7:30	<i>Dinner: on your own</i>	
8:00	Cultural activity (optional) Cat on a Hot Tin Roof	Oregon Shakespeare Festival

## Thursday, May 6

8:00 – 8:45	<i>Morning Shuttle Bus Service: pickup from hotel, drop off at Music Building</i>	
9:00 – 10:15	Invited Speakers Plenary Session	Music Recital Hall (Music Building)
10:30 – 12:00	Paper Panel Sessions	Stevenson Union, Art, Music Buildings
12:00 – 1:30	Lunch (provided)	Hannon Library, 305 (Meese Room)
1:30 – 3:00	Paper Panel Sessions	Stevenson Union, Education / Psychology Buildings
3:15 – 4:00	Impressions of the Day hosted by Ken Kempner	SC118 (Science Building)
3:30 – 5:15	<i>Afternoon Shuttle Bus Service: pickup from Music Building, drop off at hotels</i>	
4:30 & 5:30	<i>Bus to Dinner: pickup from hotels and SOU Stevenson Union</i>	
5:00 – 8:00	Dinner: Peter Brice Awards Ceremony	Callahan's Restaurant
7:30 & 8:30	<i>Bus Service: return to hotels</i>	

## Friday, May 7

8:00 – 8:45	<i>Morning Shuttle Bus Service: pickup from hotels, drop off at Stevenson Union</i>	
9:00 – 10:15	Invited Speakers Plenary Session	Rogue River Room (Stevenson Union)
10:30 – 12:00	Paper Panel Sessions	Stevenson Union Building
12:00 – 1:00	Lunch (provided)	Rogue River Room (Stevenson Union)
1:00 – 1:55	Roundtable Discussions	Rogue River Room (Stevenson Union)
2:00 – 2:45	Poster Sessions	Rogue River Room (Stevenson Union)
3:00 – 4:00	Conference Closing	Rogue River Room (Stevenson Union)
4:00 – 5:00	<i>Afternoon Shuttle Bus Service: pickup from Stevenson Union, return to hotels</i>	

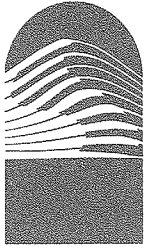

SOUTHERN  
OREGON  
UNIVERSITY

April 27, 2010

Dear PCC Participants:

Welcome to the campus of Southern Oregon University! I am delighted that SOU has the opportunity to host the Pacific Circle Consortium here in Ashland.

As president of SOU, I continually experience the amazing creative energy of this university. At SOU, not only do we offer outstanding academic programs—we also nourish the spirits of our students in a safe, beautiful campus environment. Our University mission is summarized in one sentence:

*Southern Oregon University is an inclusive campus community dedicated to student success, intellectual growth, and responsible global citizenship.*

We are committed to **connecting** our students—with faculty, with the region, and with the issues facing our global society. Students work closely with faculty. And every year several thousand of our students go out into our communities. They do civic engagement projects; they volunteer in businesses and cultural institutions such as Oregon Shakespeare Festival and Rogue Valley Symphony. They work on capstone and research projects that help agencies and businesses. Our students don't just learn theory—they put their knowledge and talents to practical use.

We offer personalized learning experiences in small classes taught by full-time faculty. In collaboration with partners throughout the southern Oregon community, we have designed curriculum that meets workforce needs, inspires creative thinking and leadership, and emphasizes practice beyond the classroom.

Moreover, central to our commitment to responsible global citizenship, SOU values opportunities for our students to study abroad—and for international students to study here at SOU. We have partnerships stretching over 40 years with the Universidad de Guanajuato in Mexico and Dankook University in South Korea as well as partnerships with international universities worldwide.

SOU is truly a special place. While you are here, I hope you will tour our campus and learn about our academic programs and student life.

Again, I wish you the warmest welcome.

Sincerely,

Mary Cullinan  
President, Southern Oregon University

Office of the President  
1250 Siskiyou Boulevard  
Ashland, Oregon 97520-5045  
Tel 541-552-6111  
Fax 541-552-6337

# Welcome to Ashland

It is my great pleasure to welcome each of you to the 34th Annual Conference of the Pacific Circle Consortium (PCC). The PCC Annual Conference brings together educators from diverse societies in a collegial and productive environment to work on regional and global topics pertinent to educational and social settings throughout the Asia-Pacific region. We hope that the 34th Annual Conference, the second to be held in Ashland, will maintain and build upon this tradition with representatives from many countries throughout the Pacific area.

This year's conference is hosted by the School of Education at Southern Oregon University, and we hope you will enjoy the SOU campus as well as the city of Ashland and the surrounding area. The goal of the 34th Annual Conference is to enhance mutual understanding and cooperation among educators and policy-makers in the Asia-Pacific Region with a special effort to put good, research-based ideas into practice in keeping with this year's theme of "Transformative Education: From Vision to Action." We have a good range of presenters as well as six featured speakers to stimulate our thinking throughout the conference.

Organizing an international conference of this scope is a huge undertaking, and it takes many hands to lighten the load. I would like to thank the Program Planning Committee members (which includes just about everyone on the Faculty of the SOU School of Education) for all of their extraordinary work to put on this conference. Indeed, the faculty of the SOU School of Education sponsored scholarships for local teachers as well as national and international students to attend the PCC conference. We wish to extend our appreciation for their generosity.

In addition, the conference sponsors also include the PCC organization, the Confucius Classroom Program at St. Mary's High School in Medford, Oregon, and the SOU Foundation. We offer our sincere gratitude to these organizations for their generous support of the program.

For individuals, I want to express my appreciation to Geoff Mills, Dean of the SOU School of Education, who introduced all of us in Ashland to the PCC and who continues to support our participation in the PCC in a variety of ways. I am also extremely grateful to Jeanne Stallman and Nicole Graham from the SOU Division of Continuing Education for their organizing efforts. In addition, William Greene initiated the organization of the conference as he pushed us in the early stages of conference development. Angela Huftill helped tremendously at every stage along the way with her knowledge of all things technical, administrative, and creative. Finally, the man behind the curtain who generated the magic to really put the program together is John King. Each of these people deserves a big "thank you" from all of us for their dynamic work to develop the 34th Annual Conference of the Pacific Circle Consortium.

I, along with my colleagues, wish you the best as you enjoy the conference and our campus community this week. We urge you to attend sessions and engage in the thought-provoking deliberations that will take place during the conference. We, as educators in the Asia-Pacific Region, have much work to put into practice the transformative educational ideas that we will discover as we learn from one another in the conference sessions. Welcome and best wishes to each of you.

Steven Thorpe, Ph.D.  
34<sup>th</sup> PCC Conference Organizer

# The Pacific Circle Consortium

The Pacific Circle Consortium (PCC) was established in 1977 as an initiative in international cooperation between educational research and development institutions in the Pacific Region which were initially drawn from Organization for Economic Co-operation and Development (OECD) countries. Australia, Canada, Japan, New Zealand and the U.S. (Mainland and Hawaii) were represented at the first meeting. Membership has since been extended to other countries from within this region and from Asia. The focus has also changed from one of collaboratively produced curriculum materials to broader issues of policy development and educational research.

From hosting yearly workshops and meetings, the organization has moved to a single yearly conference at which joint projects are discussed and reported upon and a range of papers and symposia are presented. The Consortium is now independent from the OECD, and the PCC now draws members from Australia, New Zealand, several Pacific Islands, China, the Hong Kong SAR, Japan, South Korea, Malaysia, Taiwan, Thailand, Sri Lanka, several states of the United States, Vietnam, Canada, Latvia, and México. Conference attendees have also come from Europe, the United Kingdom, Russia, Nepal and Ecuador.

Originally launched in 1987, the Pacific Circle Consortium's journal, Pacific-Asian Education (formerly Pacific Education), has established itself as an international refereed journal, which reports on PCC projects and other relevant research within the organization's purview.

The Peter Brice Award is presented annually by the conference host country to an individual who best exemplifies the aims of the PCC. Peter Brice represented New Zealand in the early days of the PCC when it was under the auspices of the OECD. He was an officer in the New Zealand Ministry of Education at the time. Upon his passing, his wife graciously worked with the PCC to develop an award in his honor. Mr. Brice is best remembered for his wisdom, his humanity and his lifelong commitment to educational ideals.

Member contributions to the Pacific Circle Consortium help to offset the costs of the annual conference and the Pacific-Asian Education Journal. Membership dues are automatically part of the registration fee to the annual conference

## Executive Committee

Chair: Meesook Kim, Korea  
Chair-Elect: Steven Thorpe, U.S.A.  
Past Chair: José Ernesto Rangel Delgado, Mexico  
Secretary: Carol Mutch, New Zealand  
Treasurer: Kathleen Berg, U.S.A.

## Board Members

Shiowlan Doong, Taiwan  
Cresantia Koyavakauta, Fiji  
Bridget O'Regan, New Zealand  
Somwung Pitiyanuwat, Thailand  
Ex Officio: Thanh Truc T. Nguyen, U.S.A.



# Southern Oregon University

With smaller classes and individual attention from faculty, you won't be a number at Southern Oregon University. Our four-year university specializes in a strong liberal arts and sciences curriculum balanced with career-focused preparation. At SOU, you will have 34 majors and more than 100 areas of study to choose from. We are committed to making the educational experience unique and enriching for all of our students.

Situated in sunny Ashland, Southern Oregon University combines quality education with a spectacular location. Surrounded by rugged mountains, rivers, and lakes, the beautiful 175-acre campus is home to 5,500 students from around the world. SOU, a four-year university specializing in liberal arts, sciences, and select graduate and professional programs, offers 100 areas of study within the College of Arts and Sciences and the Schools of Business and Education. Southern Oregon University specializes in individual attention offering small class sizes. Take a closer look and see why Southern Oregon University can take you further than you ever imagined.

## Office of International Programs

The Office of International Programs (OIP) is Southern Oregon University's central administrative unit for the coordination of international relationships, oversight of education abroad programs, provision of services to international students and scholars, recruitment of students outside the United States, and providing links between and among other campus departments and offices.

**Office of International Programs**  
**Stevenson Union Room 321**  
**1250 Siskiyou Blvd**  
**Ashland, OR 97520-5019**  
**Phone:(541) 552-6336**  
**Fax:(541) 552-8195**

The OIP is the university's main point of contact in coordinating international relationships. Its primary functions, in this context, are to assist anyone wanting to develop international contacts, programs, and exchanges, and to provide institutional perspective and guidance. Suggestions for new international partnerships can arise from a specific SOU department, from the Office of International Programs, or from any other SOU unit.

The OIP works with and empowers faculty and staff for the coordination, development, and promotion of a broad array of international education programs to prepare students for global leadership and citizenship. Programs and activities include classroom-based and experiential activities abroad. These programs foster international expertise by facilitating faculty and student international exchanges and education abroad in keeping with the quality, community, and diversity goals of Southern Oregon University.

The OIP is dedicated to serving Southern Oregon University's international community. It assists international students and scholars in successfully accomplishing the goals that brought them to the University, by using all available resources. In addition, the OIP supports SOU's international efforts by helping departments to bring new foreign nationals to our campus and communities, by coordinating events that build links between the U.S. and the international campus community. The OIP oversees the Intensive English Program (IEP), which provides opportunities for non-native speakers to improve their English language skills.

The OIP is a resource for the many existing programs throughout the campus whose activities could be enhanced by increased interaction with other international programs and initiatives.

# Confucius Classroom at St. Mary's School

The People's Republic of China has named St. Mary's School the first Confucius Classroom in North or South America. This award gives southern Oregon students and community members unprecedented access to Chinese language studies, travel to China, and friendship-building opportunities with Chinese students, teachers, and professors.

Confucius Classroom status is part of an initiative by the Chinese Ministry of Education to make Chinese language instruction and Chinese cultural studies available to high school and college students around the globe. While there are almost 300 universities in the program worldwide participating at the Confucius Institute level, including over 50 major universities in the USA, just twelve secondary schools in the world have been so honored by the Chinese government. St. Mary's is the first secondary school to receive this distinction in the Americas.

The program provides funding for St. Mary's Mandarin teachers, community classes in Mandarin, textbooks, and an exchange program with a sister school in central China, and a wealth of other opportunities. In the coming year, The Confucius Classroom at St. Mary's School has plans to extend Mandarin instruction to local elementary and middle schools and to offer instruction as well at the introductory college level.

## Conference Transportation

### *Transportation to and from the Airport*

Ashland is served by the Medford/Rogue Valley International Airport in Medford, Oregon (twenty miles north of Ashland).

Cascade Airport Shuttle (541-488-1998) and Yellow Cab (541-482-3065) both provide door to door service between the airport and Ashland hotels. Cost is \$20-\$45; further details will be sent with your registration confirmation.

### *If you are driving*

If your schedule permits you to spend a little time in the Pacific Northwest before or after the conference, there are many lovely areas to explore. Ashland is located approximately 400 miles north of San Francisco (a seven hour drive – longer if you come up the coast instead of the inland highway) and 500 miles south of Seattle (an 8.5 hour drive). The wild, rugged Oregon Coast and Redwood National & State Park on the Northern California coast are remarkable places to visit.

Interstate 5 runs north/south from Ashland and is the major highway through this area. There is a secondary highway, Highway 66, which goes over the Cascade mountains to the east, toward Klamath Falls. It is a scenic, but precipitous, route. Another less direct route from the coastal areas is off Highway 101 just north of Crescent City, California onto Highway 199. This winds along the beautiful Smith River and emerges at Grants Pass, where you may travel along Interstate 5 south for the last hour to Ashland.

# Daily Shuttle Bus

## *Service between conference hotels and SOU campus*

### Tuesday, May 4

- 12:00 – 2:15 Visits to local schools: Shuttle bus pickup from/return to hotels
- 2:30 Executive Council Shuttle Bus: pickup from hotels, drop off at Stevenson Union
- 6:00 – 6:45 Opening Reception Shuttle Bus Service: pickup from hotels, drop-off at Art Building
- 8:30 – 9:30 Opening Reception Shuttle Bus Service: pickup from Art Building, drop-off at hotels

### Wednesday, May 5

- 7:00 – 8:00 Morning Shuttle Bus Service: pickup from hotels, drop-off at Art Building
- 4:00 – 6:00 Afternoon Shuttle Bus Service: pickup from Art Building, drop-off at hotels

### Thursday, May 6

- 8:00 – 8:45 Morning Shuttle Bus Service: pickup from hotels, drop-off at Music Building
- 3:30 – 5:15 Afternoon Shuttle Bus Service: pickup from Music Building, drop off at hotels
- 4:30 & 5:30 Bus to Peter Brice Awards Dinner: pickup from hotels and SOU Stevenson Union, drop off at Callahan's Restaurant
- 7:30 & 8:30 Bus from Peter Brice Awards Dinner: from Callahan's Restaurant to SOU campus/hotels

### Friday, May 7

- 8:00 – 8:45 Morning Shuttle Bus Service: pickup from hotels, drop-off at Stevenson Union
- 4:00 – 5:00 Afternoon Shuttle Bus Service: pickup from Stevenson Union, drop-off at hotels

# Conference Accommodations

Ashland Springs Hotel Toll free: 1. 888-795-4545 / Local: 1.541.488.1700

Right in the heart of downtown Ashland, the Ashland Springs Hotel is a full-service hotel one block from the Oregon Shakespeare Festival. Here you are in the middle of it all - surrounded by great restaurants, art galleries, and wonderful shops. Breakfast, late night snack, discount at the nearby spa, and free wireless internet service included in your room rate. Located 1 mile from our conference facility; free shuttle to conference is provided. (Note: all rooms have one queen or king bed only, no rooms with two beds.) Conference rate: \$129/night plus tax.

Best Western Windsor Inn Toll Free: 1.800.334.2330 / Local: 1.541.488.2330

Located on the quiet edge of town, the beautifully landscaped Windsor Inn offers a tranquil getaway. With a heated outdoor pool and large Jacuzzi spa, well-equipped weight room, nearby restaurants, free wireless internet service, and free shuttle into downtown you have it all at your fingertips. Breakfast included in your room rate. Located one mile from our conference facility; free shuttle is provided. Conference rate: \$76.49/night plus tax – two queen beds; \$67.49/night plus tax – one king bed.

Palm Cottages Toll Free: 1.800.691.2360 / Local: 1.541.482.2636

An eco-friendly inn with an award-winning garden, The Palm is a hidden gem located adjacent to the University. High-speed wireless internet service available throughout property; surf from the privacy of your room or while lounging in the garden. Enjoy the convenience of easy access to your room between conference events; stroll the beautiful campus after conference sessions.

SOU Cox Hall (Conference Housing) Toll free 1.800.257.0577 / Local: 1.541.552.6699

Lodging right on the SOU campus makes your visit to Ashland incredibly convenient! Choose deluxe room (two double beds, private bathroom, mini-fridge, microwave and phone) or select the traditional dorm-style room (twin beds, shared hall bath, no phone). Lodging on campus requires booking all three nights of the conference (May 4, 5, and 6); additional night before and/or after is available as an optional extra. Call phone number above to make a reservation, or email Nicole, [graham@sou.edu](mailto:graham@sou.edu). Conference rate: deluxe room, \$92 per night; dorm room, \$46 per night.

# Discounted Dining Options

The following offer a 10% discount on dining for PCC Conference participants, unless otherwise noted

Allyson's Kitchen	115 East Main Street	(541) 482-2884
Miguel's Mexican Restaurant	545 Clover Lane	(541) 488-7788
Senor Sam's Mexican Restaurant	1634 Ashland St	(541) 488-1262
Winchester Inn	35 S Second St	(541) 488-1113
Loft American Brasserie & Bar	18 Calle Guanajuato	(541) 482-1116
Paddy Brannan's Irish Pub, LLC	23 S Second St	(541) 488-5770
Mihama Teriyaki Grill	1253-B Siskiyou Blvd.	(541) 488-3530
<i>Free drink with meal</i>		

# Other Dining Options

Alex's Plaza Restaurant and Bar <i>35 N Main St</i>	Great American Pizza Co <i>1448 Ashland St</i>	Pasta Piatti <i>358 E. Main St.</i>
Amuse Restaurant <i>15 North First St.</i>	Greenleaf Restaurant <i>49 N Main St</i>	Peerless Restaurant <i>265 Fourth St</i>
Apple Cellar Bakery & Bistro <i>2255 Highway 66</i>	Grilla Bites Restaurant <i>47 North Main St</i>	Sesame Asian Kitchen <i>21 Winburn Way</i>
Beasy's on the Creek <i>51 Water St</i>	Hana Sushi, LLC <i>29 N. Main St</i>	Standing Stone Brewing <i>101 Oak St</i>
Big Town Hero <i>75 N Main St</i>	House of Thai Cuisine <i>1667 Siskiyou Blvd</i>	Tabu <i>76 N. Pioneer Street</i>
Black Sheep <i>51 N. Main St</i>	Larks Home Kitchen Cuisine <i>212 East Main Street</i>	TAJ Indian Cuisine <i>31 Water Street</i>
Brothers Restaurant & Deli <i>95 N Main St</i>	Lela's Cafe <i>258 A Street #3</i>	Tease Restaurant & Bar <i>303 E. Main Street</i>
Caldera Tap House <i>31 Water Street</i>	Liquid Assets <i>96 N. Main Street #201</i>	Thai Pepper <i>84 North Main Street</i>
Chateaulin Restaurant <i>50 E Main</i>	Zoey's Cafe <i>199 E. Main Street</i>	The Pita Pit <i>145 East Main Street</i>
Creskide Pizza Bistro <i>92 1/2 Water St</i>	Louie's Bar & Grill <i>41 N. Main St.</i>	Torero's Mexican Restaurant <i>2345 Ashland Street #205</i>
Cucina Biazzi <i>568 E Main</i>	Macaroni's Ristorante <i>58 E Main St</i>	Wild Goose <i>2365 Ashland Street</i>
Dragonfly Restaurant <i>241 Hargadine St.</i>	Omar's Seafood & Steaks <i>1380 Siskiyou Blvd</i>	Yogurt Hut <i>140 Lithia Way</i>
El Tapatio Mexican Restaurant <i>2075 N Pacific Hwy</i>		

# Internet Access

*Conference participants may access the internet in three ways.*

1) From your personal laptop: Log on to the wireless internet at the [www.sou.edu](http://www.sou.edu) website.

Once the SOU server verifies that your anti-virus software is up-to-date, you will be able to log on as a “guest” for internet use (if your laptop anti-virus software needs to be updated, the SOU web site will do that automatically and then you will be able to log on to the SOU web site as a “guest”).

2) From the Hannon Library lobby

Any person can use the desktop computers at the round tables in front of the Reference Desk (to your right as you enter the building) if they show identification (such as a passport or driver’s license). You will be able to use one of these computers up to 2 hours.

3) From the computer labs in the Education-Psychology Building and the Computer Science Building:

Log on using “guest” as your password. Please note that the Education-Psychology computer lab may be unavailable during certain time periods due to class meetings.

# Electronic Conference Proceedings

Electronic Conference Proceedings will be assigned an ISBN number and published through a link on the conference website, <http://www.sou.edu/pcc2010/>

ISBN # 978-0-615-36636-4

The Pacific Circle Consortium will hold the copyright to all papers unless the author makes prior arrangements. Please be advised, if you wish to submit your PCC paper to another journal, many publications do not accept previously published work. The PCC, however, will grant permission for papers to be republished, without cost, in other publications that accept such work. We advise authors who plan to resubmit their work either to check the publication guidelines of the proposed journal or not submit their PCC paper for publication in the conference proceedings.

# The Pacific-Asian Education Journal

Originally launched in 1987 the Pacific Circle Consortium’s journal, Pacific-Asian Education (formerly Pacific Education), has established itself as an international refereed journal which reports on PCC projects and other relevant research within the organization’s purview. Since 2008, the journal has transitioned to an online format.

For journal information, please email us at [info@pacificcircleconsortium.org](mailto:info@pacificcircleconsortium.org) with the subject line: PAE Journal

Please note that PCC members who work on the Pacific-Asian Education Journal do so from a personal standpoint and as individual entities. In no way are their professional institutions responsible for the work and viewpoints expressed in the PAE nor do their institutions endorse the PAE in any specific manner.

# Daily Schedule: Tuesday, May 4

12:00 – 2:15	<i>Visits to local schools (shuttle bus pickup/return to hotels)</i>	
2:30	<i>Executive Council Shuttle Bus: pickup from hotels</i>	
3:00 – 6:00	PCC Executive Council Meeting	Guanajuato Room (Stevenson Union, 315)
4:00 – 8:00	Conference Registration	Thorndike Art Gallery (Art Building)
6:00 – 6:45	<i>Shuttle Bus Service: pickup from hotels</i>	
7:00 – 9:00	Opening Reception	Thorndike Art Gallery (Art Building)
	Speakers: Geoff Mills, Mary Cullinan, Meesook Kim and Frank Phillips	
	Performances by Confucius Classroom and Ballet Folklorico	
8:30 – 9:30	<i>Shuttle Bus Service: from SOU campus to hotels</i>	

# Daily Schedule: Wednesday, May 5

7:00 – 8:00	<i>Morning Shuttle Bus Service: pickup from hotels</i>	
8:00 – 12:00	Conference Registration	Thorndike Art Gallery (Art Building)
8:00 – 9:30	Conference Welcoming & Recognition of Country	Meese Auditorium (Art Building)
	Speakers: Meesook Kim, Geoff Mills, Brent Florendo, and David West Performance by SOU Native American Drummers	
9:30 – 10:30	Invited Speakers Plenary Session	Meese Auditorium (Art Building)
	Kerry Kennedy and Walter Parker, hosted by Steve Thorpe	
11:00 – 12:30	Paper Panel Sessions	
	Session 1	SU 306 (Stevenson Union)
	Session 2	SU 315 (Stevenson Union)
	Session 3	SU 319 (Stevenson Union)
	Session 4	SU 330 (Stevenson Union)
12:30 – 1:30	Lunch (provided):	
	International participants	Hannon Library, 305 (Meese Room)
	US participants	Guanajuato Room (Stevenson Union, 315)
1:45 – 3:15	Paper Panel Sessions	
	Session 5	SU 315 (Stevenson Union)
	Session 6	SU 319 (Stevenson Union)
	Session 7	SU 330 (Stevenson Union)
	Session 8	SU 306 (Stevenson Union)
3:30 – 4:00	Impressions of the Day hosted by William Greene	Hannon Library, 305 (Meese Room)
4:15 – 5:45	General Assembly meeting	Hannon Library, 305 (Meese Room)
4:00 – 6:00	<i>Afternoon Shuttle Bus Service: from Art Building to hotels</i>	
6:00 – 7:30	Dinner: on your own	
8:00	Cultural activity (optional) Cat on a Hot Tin Roof	Oregon Shakespeare Festival



# Wednesday Invited Speakers

## **Professor Kerry Kennedy**

Professor Kennedy has an MA and PhD from Stanford University, an MEd from the University of New South Wales in Australia and an MLit from the University of New England in Australia. His undergraduate education was completed at the University of New South Wales. He worked as a secondary school teacher in Australia before taking up academic positions at a number of Australian universities. His last position in Australia was Pro Vice-Chancellor (Academic) at the University of Canberra. He has lived and worked in Hong Kong since 2001. He is currently Chair and Professor of Curriculum Studies at The Hong Kong Institute of Education where he also holds the positions of Dean of the Faculty of Education Studies and Associate Vice-President (Quality Assurance). He researches and writes in the area of curriculum policy and theory with a particular emphasis on citizenship education. His most recent publication is *The Changing Roles of Schools in Asian Societies - Schools for the Knowledge Society* (Routledge, 2008). The 4th Curriculum Construction will be published by Pearson Education in Australia early in 2010 and *Citizenship Pedagogies in Asia and the Pacific* that he co-edited with Wing On Lee and David Grossman will be published by Springer in mid-2010. He is the General Series Editor of the Routledge Series on Schools and Schooling in Asia and the General Editor of the Hong Kong Teacher Education Series for Hong Kong University Press.

## **Walter Parker**

Walter Parker is a professor of social studies education and political science at the University of Washington, Seattle. His research focuses on social studies education generally and specifically on the tensions among three curriculum movements—democratic citizenship education, multicultural education, and global/international education. Presently, he is conducting a design experiment to align the Advanced Placement Government and Politics curriculum with contemporary research on how people learn. Formerly, he was a social studies teacher, department chair, and professional development director in the Colorado public schools. His new book is *Social Studies Today: Research and Practice* (Routledge, 2010). Prior books include *Educating the Democratic Mind* (1996), *Teaching Democracy: Unity and Diversity in Public Life* (2003), and *Social Studies in Elementary Education*, 14th ed. (2009). His most recent article is “The New ‘International Education’ Movement in U.S. Public Schools” which appears in the British journal, *Globalisation, Societies & Education*.

# Wednesday Morning Presentations, 11:00 – 12:30

## Session 1 (Stevenson Union, Room 306)

Frank Pottenger, University of Hawaii, College of Education, Curriculum Research & Development Group, USA Prerequisites of Transformative Education

Louise Pare, Independent Consultant/Scholar, Ashland, Oregon, USA Reflecting on a Moving Experience: Transformational Movement, Conscious Embodiment, Women's Spirituality and Social Activism

Jo-Anne Lau-Smith, Southern Oregon University, USA Self-Study of Teacher Transformation

## Session 2 (Stevenson Union, Room 315)

Lindsey Conner, University of Canterbury, New Zealand Teacher Research on Developing Cultural Congruence in New Zealand Science Classrooms

Hyang-yon Rhee, Kyunghye Choi & Sungsoo Song, Ewha Woman's University, Korea Ethics Education in Science and Technology

Thomas Christ, University of Hawaii Center On Disability Studies, USA The Ka hihi Project: Culturally Connected Math and Science Web-Quests

## Session 3 (Stevenson Union, Room 319)

Carol Mutch, Education Review Office, New Zealand & Akira Ninomiya, Open University of Japan A Conceptual Framework for Exploring Education System Development

Ernesto Rangel & Angel Licona Michel, University of Colima, Mexico Higher Education, New Technologies and Employment in South Korea and Mexico: Policies and Professional Labor Market

John T. King, Southern Oregon University, USA Looking to the Future through the Eyes of the Past: The Essential Skills Movement and the Challenges of Transformation

## Session 4 (Stevenson Union, Room 330)

David Grossman, Chaminade University of Honolulu, USA Alternative Routes for Teacher Preparation: Fast Tracks or Dead Ends?

Rosilyn Carroll, Center for Excellence in Urban Teaching, Hamline University & Sandra Darling, Learning Bridges, California State University - Bakersfield A "Fast Train" to the Redesign of Teacher Education That Drives Higher Academic Achievement for a Culturally Diverse Student Population

Ronnie Davey & Vince Ham, University of Canterbury, New Zealand Why, and How, Do Teachers 'Become' Teacher Educators?

# Wednesday Afternoon Presentations, 1:45 – 3:15

## Session 5 (Stevenson Union, Room 315)

Shiowlan Doong, National Taiwan Normal University, Taiwan	Moral Indoctrination versus Democratic Education: The Rhetoric and Practice of Taiwan's Citizenship Education
Maria Eugenia Luna-Elizarraras, Consultant on Citizenship Education, Mexico	Citizenship Education: An Overview of the Latin American Region
Amy Belcastro, Southern Oregon University, USA	Purposeful Persistence: First Generation College Student Success

## Session 6 (Stevenson Union, Room 319)

Michael Furlong, University of California, Santa Barbara, USA	Ready or Not, Here I Come: School Readiness Assessment Strategies
Li-hua Chen, Pao-jing Chan & Da-Xuan Chen, Taipei Municipal University of Education, Taiwan	A New Horizon of Global Issue-Centered Curriculum: A Civic Action Approach
Wilkins-O'Riley Zinn, Susan Faller-Mitchell, Southern Oregon University, USA	Banish Boredom! Building Student Engagement Through the Six Skills of Interest

## Session 7 (Stevenson Union, Room 330)

Maria Navarro, Lourdes Pacheco Ladron de Guevara, Elva Anzaldo Velazquez, Universidad Autonoma De Nayarit, Mexico	A University with a Sense of Self
Thomas Wang, Fu Jen Catholic University & Fei-Ching Chen, Professor National Central University, Taiwan	A Sociological Aspect of Carbon Reduction Emission on Campus: A Recent Experience in Taiwan
Kay Sagmiller, Southern Oregon University, USA	Developing a Coherent Design in Higher Education Curricula

## Session 8: Teacher Education for the Future Symposium (Stevenson Union, Room 306)

Bonni Gourneau, Jodi Holen & Woei Hung, University of North Dakota, USA	Supporting Purpose-Driven Teaching at the University of North Dakota: A Teacher Education for the Future Project
-------------------------------------------------------------------------	------------------------------------------------------------------------------------------------------------------

Discussion of Project Updates and Future Directions

# Daily Schedule: Thursday, May 6

8:00 – 8:45	<i>Morning Shuttle Bus Service: pickup from hotels</i>	
9:00 – 10:15	Welcoming by Marvin Woodard Invited Speakers Plenary Session, hosted by Steve Thorpe David Grossman and Cresantia Koya	Music Recital Hall (Music Building)
10:30 – 12:00	Paper Panel Sessions	
	Session 9	Art 124 (Art Building)
	Session 10	SU 319 (Stevenson Union)
	Session 11	SU 330 (Stevenson Union)
	Session 12	Music Recital Hall (Music Building)
12:00 – 1:30	Lunch (provided)	Hannon Library, 305 (Meese Room)
1:30 – 3:00	Paper Panel Sessions	
	Session 13	EP 195 (Ed-Psych Building)
	Session 14	SU 319 (Stevenson Union)
	Session 15	SU 330 (Stevenson Union)
3:15 – 4:00	Impressions of the Day hosted by Ken Kempner	SC118 (Science Building)
3:30 – 5:15	<i>Afternoon Shuttle Bus Service: to hotels</i>	
4:30 & 5:30	<i>Bus to Dinner: pickup from hotels and SOU Stevenson Union Building</i>	
5:00 – 8:00	Dinner: Peter Brice Awards Ceremony Speakers: Meesook Kim, Mary Cullinan, Jim Klein, and Geoff Mills Performance by Old-Time Fiddlers	Callahan's Restaurant
7:30 & 8:30	<i>Bus Returns: to hotels and SOU campus</i>	

# Thursday Invited Speakers

## **Cresantia Koya**

Cresantia Koya teaches at the University of the South Pacific (USP), in Suva Fiji. She lectures in Education with special interests in sustainable development, social diversity and justice, Pacific studies, and the arts as a social learning tool. Her first collection of poetry, ‘of schizophrenic voices...,’ was published in 2003 by the Pacific Writing Forum, Department of Language and Literature, USP, Suva, Fiji. She is currently working on two collections, “Without Apology” and “Marking their stories on my skin” which examines, through verse, issues of ethnicity, social commentary, and diaspora. She is currently Acting-Director at the Oceania Centre for Arts, Culture, and Pacific Studies at USP.

## **Professor David Grossman**

Professor Grossman’s wide-ranging record of research and scholarship includes citizenship education; global, comparative and intercultural education; teacher education; and social studies education and pedagogy. Currently the Dean of Education at Chaminade University of Honolulu, Prof. Grossman is also an Adjunct Senior Fellow of the East-West Center’s Education Program, and an Affiliate Graduate Faculty Member of the Education Foundations Department in the College of Education at the University of Hawai’i Manoa. From 1995-2007, Dr. Grossman was on the faculty of the Hong Kong Institute of Education, where he served as a Dean from 2002-2007. Previously he founded and served as the Director of the Stanford University Program on International and Cross-Cultural Education (SPICE). He has also been a secondary school social studies teacher and co-Director of an alternative secondary school. He holds masters degrees in East Asian Studies and Social Studies Education from Harvard University, and a Ph.D. in International Development Education from Stanford University. His recent publications include three co-edited books, *Social Education in Asia* (with Joe Lo), *Citizenship Curriculum in Asia and the Pacific* (with Kerry Kennedy and Wing On Lee), and *Improving Teacher Education through Action Research* (with Hui Ming Fai). Other recent publications include a book chapter, “‘Talking’ about Pedagogy: Classroom Discourse and Citizenship Education” and an article, “Democracy, citizenship education, and inclusion: A multi-dimensional approach”. He is also an Associate Editor for *Education about Asia*.

# Thursday Morning Presentations, 10:30 – 12:00

## Session 9 (Art Building, Room 124)

Mike Rousell, Southern Oregon University, USA	Using the Wiki as a Student-Presentation Tool
Jodi Holen & Bonni Gourneau, University of North Dakota, USA	A Move Toward Core Reflection
Dennis Jablonski, Jessica Rohrbough & Callie McQueen, Southern Oregon University, USA	Cultural Issues in Re-training Traditional Midwives in Rural Southeastern Sierra Leone

## Session 10 (Stevenson Union, Room 319)

Tasha Wyatt & Chen Ju Lin, University of Hawaii-Manoa, USA	Instructional Coaching and Teachers' Understanding and Use of Pedagogical Strategies
Kristy McGinnis, Glenda Moss & Christine Macfarlane, Pacific University, Oregon, USA	Learning Portfolios: Transforming Candidates, Faculty and Programs
LeoNora Cohen, Kathryn Ciechanowski, Kathleen Cowin & Rick Orozco, Oregon State University, USA	Crafting Journal Articles: Our Mentoring Portraiture

## Session 11 (Stevenson Union, Room 330)

Misao Makino, Mariko Gakiya & Gerald W. Fry, Mejiro University, Japan	Women Entrepreneurs in Japan and Thailand: A Comparative Study of Transformative Leadership for Innovation and Change
Raj Parikh, School of Business, Southern Oregon University, USA	Ensuring Excellence in Higher Education: Vision and Reality - the Case of UAE
Hui-Jane Yang, I-Shou University, Taiwan	Children's Self-esteem Development and Education Issues in the Family of Foreign Spouses in Taiwan

## Session 12 (Music Recital Hall, Music Building)

Brent Florendo, Native American Studies, Southern Oregon University, USA	Traditional and Contemporary Native American Perspectives through Drumming and Dance, an interactive workshop
--------------------------------------------------------------------------	---------------------------------------------------------------------------------------------------------------

# Thursday Afternoon Presentations, 1:30 – 3:00

## Session 13 (Education-Psychology Building, Room 195)

Amy Belcastro & Vicki Purslow, Southern Oregon University, USA	A Developmental Framework for Institutions Serving the 21st Century College Student
Gwo Jen Lin, Show-Mann Liou, Yao-Jung Lin & Hsien-Cheng Chen, National Changhua University of Education, Taiwan	The Relationship between the Effectiveness of Qualitative Indicators of School Actualization Project and School Organizational Execution in Taiwan
Caroline Storm, Southern Oregon University McNair Scholar, USA	Cultural Issues in Re-training Traditional Midwives in Rural Southeastern Sierra Leone

## Session 14 (Stevenson Union, Room 319)

Kyoung-Ah Nam & Gerald W. Fry, University of Minnesota, USA	Innovative Short-Term Study Abroad: Transformative Learning for Global Engagement
Frank Phillips, St. Mary's High School & Jay Matheson, Southern Oregon Educational Services District	The Confucius Classroom at St. Mary's School and Southern Oregon Education Service District
Li-mei Lin, Oregon State University, USA	Integrating Multicultural Education and Web2Quest into Teacher Education: A Potential for Globalization

## Session 15 (Stevenson Union, Room 330)

Angus Macfarlane, University of Canterbury, New Zealand	Above the Clouds - Māori Soaring at School
Helen Slaughter, University of Hawaii, College of Education, USA	Using the Regional Literature of and about Hawai'i in School: A Complicated Conversation for Curriculum
Barbara Shin, Independent Scholar, Minneapolis, MN & Rosilyn Carroll, Hamline University School of Education, USA	The Critical Value of Culture to the Teaching/Learning Process as well as to School Leadership in Culturally Diverse Societies

# Daily Schedule: Friday, May 7

8:00 – 8:45	<i>Morning Shuttle Bus Service: pickup from hotels</i>	
9:00 – 10:15	Welcoming by International Student Association	Rogue River Room (Stevenson Union)
	Invited Speakers Plenary Session, hosted by Steve Thorpe Lois Yamauchi and Roland Tharp	
10:30 – 12:00	Paper Panel Sessions	
	Session 16	SU 306 (Stevenson Union)
	Session 17	SU 313 (Stevenson Union)
	Session 18	SU 319 (Stevenson Union)
	Session 19	SU 330 (Stevenson Union)
12:00 – 1:00	Lunch (provided)	Rogue River Room (Stevenson Union)
	Performance by SOU Dulcet Group	
1:00 – 1:55	Roundtable Discussions	Rogue River Room (Stevenson Union)
2:00 – 2:45	Poster Sessions	Rogue River Room (Stevenson Union)
3:00 – 4:00	Conference Closing	Rogue River Room (Stevenson Union)
	Speakers: Meesook Kim, William Greene, and Lindsey Connor	
	Performance by SOU Hawaiian Student Group	
4:00 – 5:00	<i>Afternoon Shuttle Bus Service: from SOU Stevenson Union to hotels</i>	
	Local Cultural Activities (optional)	
5:00 – 8:00	First Friday Art Walk	Downtown Ashland Plaza
7:00 – 9:00	SOU International Show	Music Recital Hall



# Friday Invited Speakers

## **Roland Tharp**

Roland Tharp's publications include hundreds of articles, chapters, and books on issues of diversity in educational practice, psychological theory, and human service delivery. He is a major contributor to research, practice, and educational reform, the development of sociocultural theory, and community psychology. He was Principal Investigator of the Kamehameha Early Education Program (KEEP) for 20 years. His book, *Rousing Minds to Life* (Tharp & Gallimore, Cambridge University Press, 1989), achieved an integrated theory of education and was awarded the 1993 Grawemeyer Prize. He then became Director of the Center for Research on Education, Diversity & Excellence (CREDE), the US Department of Education's national research center on diversity. A prize-winning poet, fiction writer, and filmmaker, he is now Research Professor of Education at the University of California at Berkeley, Professor at the University of Greenland, and Emeritus Professor at the University of California at Santa Cruz and the University of Hawai'i at Mānoa.

## **Lois A. Yamauchi**

Lois A. Yamauchi is Professor and Chair of the Department of Educational Psychology at the University of Hawai'i at Mānoa and the Director of the CREDE Hawai'i Project. Her research interests include sociocultural theory, cultural influences on learning, and the educational experiences of indigenous teachers, students, and families. She developed a professional development program to promote teachers' use of effective instructional strategies for culturally and linguistically diverse students and recently collaborated with early childhood educators to adapt the strategies for preschoolers.

# Friday Morning Presentations, 10:30 – 12:00

## Session 16 (Stevenson Union, Room 306)

Erin Wilder, Southern Oregon University, USA	Characteristics of Effective Collaboration Among Innovative Early Childhood Intervention Programs
Paul Deering, Deborah Zuercher & Sheila A. Apisa, University of Hawai'i at Mānoa, USA	An 'Ohana Approach to Developing Leadership with Multicultural Middle Level Educators
David West, Southern Oregon University, USA	Konaway: Development and Implementation of a High School Intervention and Retention Program for Native American Students

## Session 17 (Stevenson Union, Room 313)

Katherine Ratliffe, University of Hawaii, USA	Effective Strategies for Teaching Pacific Island Educators
Niusila Faamanatu-Eteuati, Samoa	Teachers' Perspectives about the Current Status of Inclusive Education in Samoa: Where to Next?
Angie Crum, Gregg Gassman & John King, Southern Oregon University, USA	Preparing the Inclusive Educator: Promoting Collaborative Practice between General Education and Special Education Pre-service Teachers

## Session 18 (Stevenson Union, Room 319)

Roni Adams, William Greene & Younghee Kim, Southern Oregon University, USA	Cultivating the Whole Teacher: Sustaining Authenticity and Ideals Beyond the MAT Program
Gwo Jen Lin, Show-Mann Liou, Yao-Jung Lin & Yi-Jen Yang, National Changhua University of Education, Taiwan	A Study on the Relationship between Teachers' Servant Leadership and Teacher Commitment
Morris Lai, University of Hawaii, USA	Past, Current, and Future Effects of the UN Declaration on Indigenous Peoples' Rights

## Session 19: CDRG Symposium (Stevenson Union, Room 330)

Donald Young, Kathleen Berg, Paul Brandon, Carol Brennan, Boyce Brown, Kanesa Duncan, Michael Gilbert, Terry Ann Higa, Ricardo Lorenzana, Eric Nakamura, Thanh Truc Nguyen, Melfried Olson, Elliott Oshiro, Frank Pottenger, Thomas Scarlett, James Schlosser, Hannah Slovin, Linda Venenciano, and Faye Zenegami, Curriculum Research & Development Group, University of Hawai'i at Mānoa, USA	A Model for Designing and Evaluating K–12 Professional Development at Multiple Organizational Levels
-------------------------------------------------------------------------------------------------------------------------------------------------------------------------------------------------------------------------------------------------------------------------------------------------------------------------------------------------------------------------------------------------	------------------------------------------------------------------------------------------------------

# Friday Afternoon Roundtable Discussions, 1:00 – 1:55

Table Number: (Stevenson Union, Rogue River Room)

1	Laura Ortiz, National University of Education Science, Mexico	Mass Media Communication: a Central Role for Civic Education
2	Truc Nguyen, University of Hawaii, USA	Internet Safety Programs
3	Alexis Siteine, The University of Auckland, New Zealand	The Representation of Pacific Peoples in New Zealand School Journals
4	Chie Nakajima, Kyoto Bunkyo Junior College, Japan & Carol Mutch, Education Review Office, New Zealand	Comparative Study on Quality Assurance Mechanism for Early Childhood Education in Japan and New Zealand
5	Francie Bostwick, Southern Oregon University	Analyzing the Cognitive Demand of Mathematical Tasks
6	Ahava Oblack, Southern Oregon University, and Jeff Painter, Southern Oregon Education Service District	Incorporating Indigenous Content and Voice in Education: A Community-Driven, Place-Based Approach in Southern Oregon
7	Kathryn Thomas, Empirical Education Inc, Ashland, OR, USA	P-12 Research Evolves from “Scientifically-Based Research” to “Effective Local Strategies.”
8	Heidi Olividati, Southern Oregon University	Mentoring for Equity: Supporting New Teachers in the First Two Years
9	Gerry McCain, Southern Oregon University, Javier Del Rio, Talent Middle School & Megan Stewart, Phoenix Elementary School, USA	Teaching English as a Second Language
10	Gary Miller, Southern Oregon University Office of International Programs	A Hands-on Introduction to Using Vietnam War Films in an American History and Social Studies Classes
11	Bridget O-Regan, Peter Coolbear, Kirsty F. Weir & Warren Sellers, National Centre for Tertiary Teaching Excellence, New Zealand	The State of and Progress Towards a Unified Approach to Higher Education Research in New Zealand
12	Douglas Smith, Gloria Herrera & Kelly McAllister, Southern Oregon University	Effects of Classroom Climate on Student Engagement and Mental Health
12	Douglas Smith, Michael Furlong & Megan Zurawski, Southern Oregon University	Co-vitality and Mental Health among College Students

# Friday Afternoon Poster Presentations, 2:00 – 2:45

Station Number: (Stevenson Union, Rogue River Room)

- |    |                                                                                                                |                                                                                                                                                             |
|----|----------------------------------------------------------------------------------------------------------------|-------------------------------------------------------------------------------------------------------------------------------------------------------------|
| 13 | Mark Sherbow, Ashland School District,<br>USA                                                                  | Learning Circles: Highly Engaging, Authentic Learning Experiences with other Elementary Classrooms from Around the World with Integrated Technology         |
| 14 | Carol Mutch, Education Review Office & Alexis Siteine, The University of Auckland,<br>New Zealand              | Writing for the Pacific-Asian Education journal                                                                                                             |
| 15 | Matthew Hiller, Southern Oregon<br>University                                                                  | Using Response to Intervention: Keeping Students in the General Education Classroom with Proper Supports                                                    |
| 16 | Sheri Fitzgerald, Univeristy of Hawai'i at<br>Mānoa                                                            | Place-Based Science Education: Finding Our Ecological Identities and Place-Connections Through the Processes of Sustainability Science                      |
| 17 | Dennis Jablonski, Jessica Rohrbough,<br>Callie McQueen, Jay Knodel, Mark Easton,<br>Southern Oregon University | Developing Literacy Through Digital Audio-Books                                                                                                             |
| 18 | Zoryn Thompson & Elisa Hawksley,<br>Southern Oregon University                                                 | Native American Perspectives in History Curriculum: Developing Understanding of Social Justice through Multicultural Awareness in the Elementary Classroom. |
| 19 | Jamie Cooper, Kelly Martin, Amber<br>Jones, Lauren Holguin, Southern Oregon<br>University                      | Teacher Education Student Poster Projects                                                                                                                   |

# The Peter Brice Award

The Peter Brice Award is presented annually by the conference host country to an individual who best exemplifies the aims of the PCC. Peter Brice represented New Zealand in the early days of the PCC when it was under the auspices of the OECD. He was an officer in the New Zealand Ministry of Education at the time. Upon his passing, his wife graciously worked with the PCC to develop an award in his honor. Mr. Brice is best remembered for his wisdom, his humanity and his lifelong commitment to educational ideals.

This year's recipient of the Peter Brice Award is Juli Di Chiro, Superintendent of Ashland School District. In Juli Di Chiro's words, "I became a teacher because I wanted to change the world, and I saw public education as the strongest vehicle to drive social justice and societal change." In a career in education spanning more than 35 years, Juli Di Chiro has indeed lived up to her dream of promoting social justice and change through her work as a teacher, principal, and superintendent.

Juli's started her teaching career in a 4/5 classroom in southern California in 1974 and worked within an inner city school where 100% of the students qualified for free or reduced lunch and over 25 languages were spoken. Surrounded by poverty, gangs, drugs, and prostitution, Juli initiated a career dedicated to social justice and change. Juli moved to southern Oregon in 2000 as Superintendent of the Ashland School District after a distinguished career as a teacher and principal in California and immediately became a voice for social justice and change in Oregon. In Juli's words, "I feel a moral imperative to devote my time and passion to ensuring that schools serve all kids well, and our rapidly changing, global society has added even more immediacy to that commitment." Juli's commitment to children received national recognition in 2009 when she was named the Oregon Superintendent of the Year. Juli has been a valuable partner with Southern Oregon University through her work to develop administrator licensure programs as well as teaching in the programs as her busy schedule permits. Juli Di Chiro is truly a champion of social justice and change and a worthy recipient of the Peter Bryce Award.

# The Arthur R. King Jr. Award for Curriculum Innovation

Dr. Arthur R. King, Jr., a founding member of the Pacific Circle Consortium, exemplified the ideals of a liberal education based on the disciplines of knowledge. He was deeply committed to the import of curriculum in improving teaching and learning, believing that improved student learning required curricula specifically crafted and proven to support innovative teaching. King was also committed to the vision of international collaboration in curriculum development, especially in the areas of multi-national, multi-cultural, and environmental understanding in the Asia-Pacific region. He was active in much of the PCC's early curriculum and research work, and he embraced positive, innovative, and exploratory approaches to learning and teaching in schools.

His professional life was devoted to curriculum research and development as the visionary founder and long-time director of the Curriculum Research & Development Group (CRDG) at the University of Hawaii. King was a strong promoter of and advocate for a comprehensive liberal arts curriculum for all students. He was able to put his belief—that the curriculum designed for the best must be equally available to the rest—into practice when he was charged with reorganizing and repurposing the University of Hawaii Laboratory School as a center for curriculum development. The center he created and directed for nearly forty years was based on the notion of the classroom as a community of scholars where each student was cast in the role of authentic practitioner. The work that he led, and that CRDG continues to do, has resulted in cutting edge research, curricula based on inquiry within the disciplines of knowledge, and professional development programs that have impacted generations of educators in Hawaii and around the world.

## **Dr. Francis M. Pottenger, III**

Dr. Francis M. Pottenger, III, a student and colleague of Dr. Arthur R. King, Jr., was among those who founded the PCC, and he has been an active participant in numerous PCC projects since its inception. As the selection committee affirmed, Pottenger is an extraordinary candidate for this prestigious award, having made significant contributions in elementary and secondary programs in and about the Asia-Pacific region.

The impact of Pottenger's work in curriculum innovation, and through it, the improvement of teaching practice in schools across the region, is unmatched. Pottenger has worked with an amazing diversity of people over the course of his career across the Asia-Pacific region. He was one of the designer/developers of PCC's The Ocean Project; he created programs and provided professional development for teachers in health and science throughout Micronesia; he has engaged in long-standing science curriculum collaborations with colleagues in Japan and Korea and in science curriculum experimentation in Australia and New Zealand. More recently, Pottenger engaged in cross-national civic education curriculum development and teacher preparation with colleagues in eastern Russia.

As the nomination letter states, "Given the breadth and scope of Frank's work, I can't recall a colleague, nationally or internationally in the curriculum field, that has impacted so many nations and the individuals in them than has Frank. He is an exemplar to us all."

# Conference Maps

## Southern Oregon University

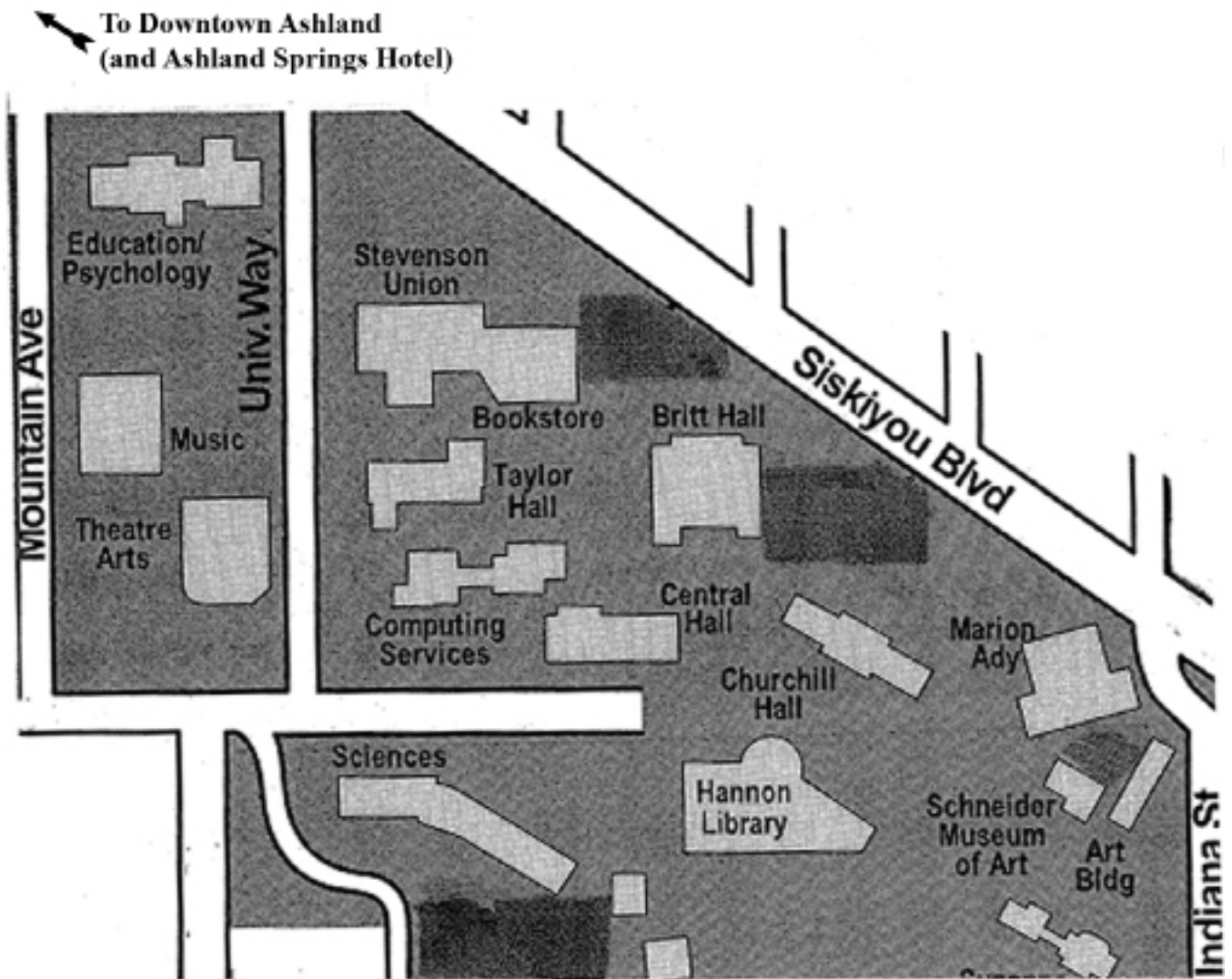



# Stevenson Union Building

## Second Floor

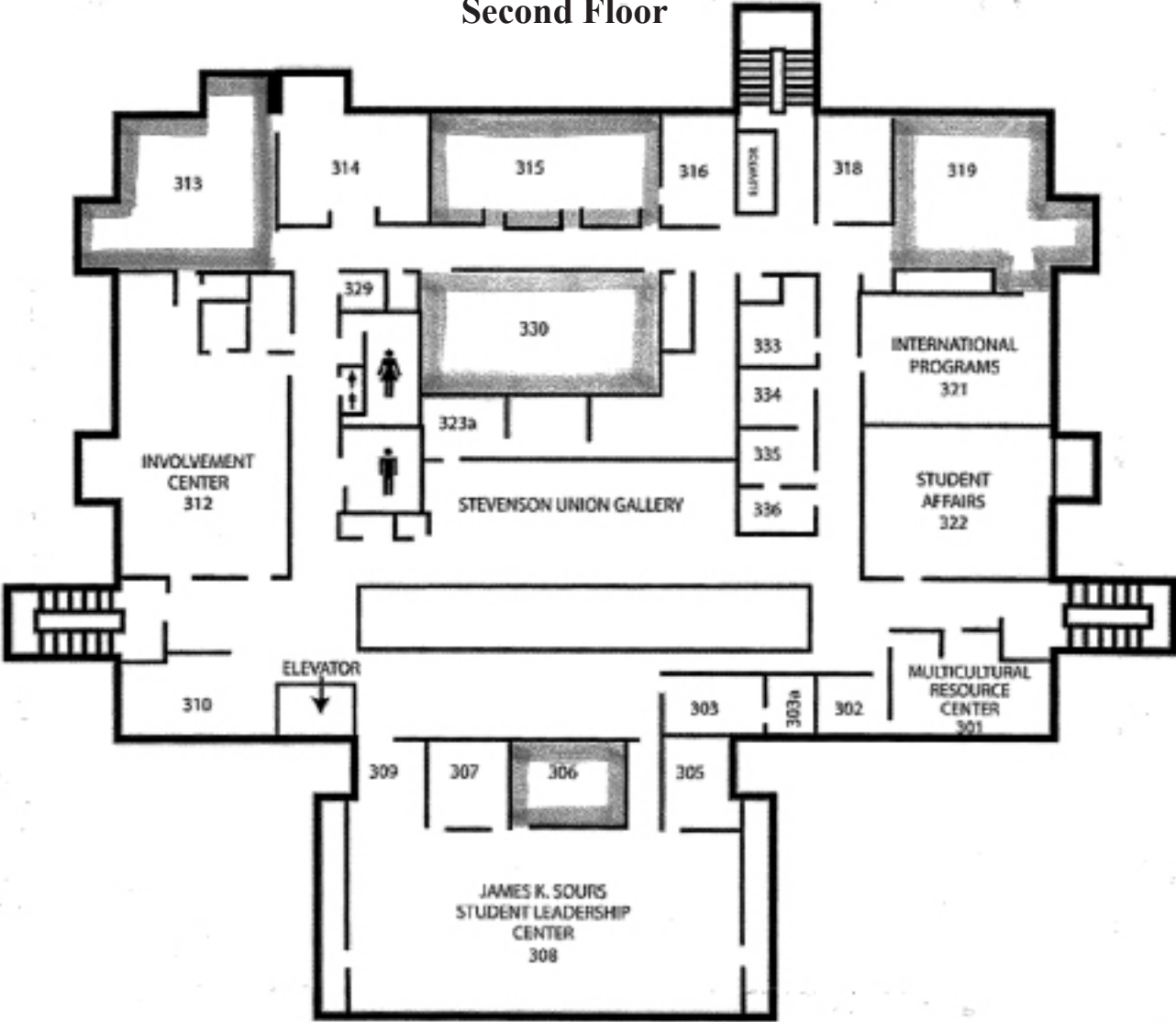



# Hannon Library Building

## First Floor

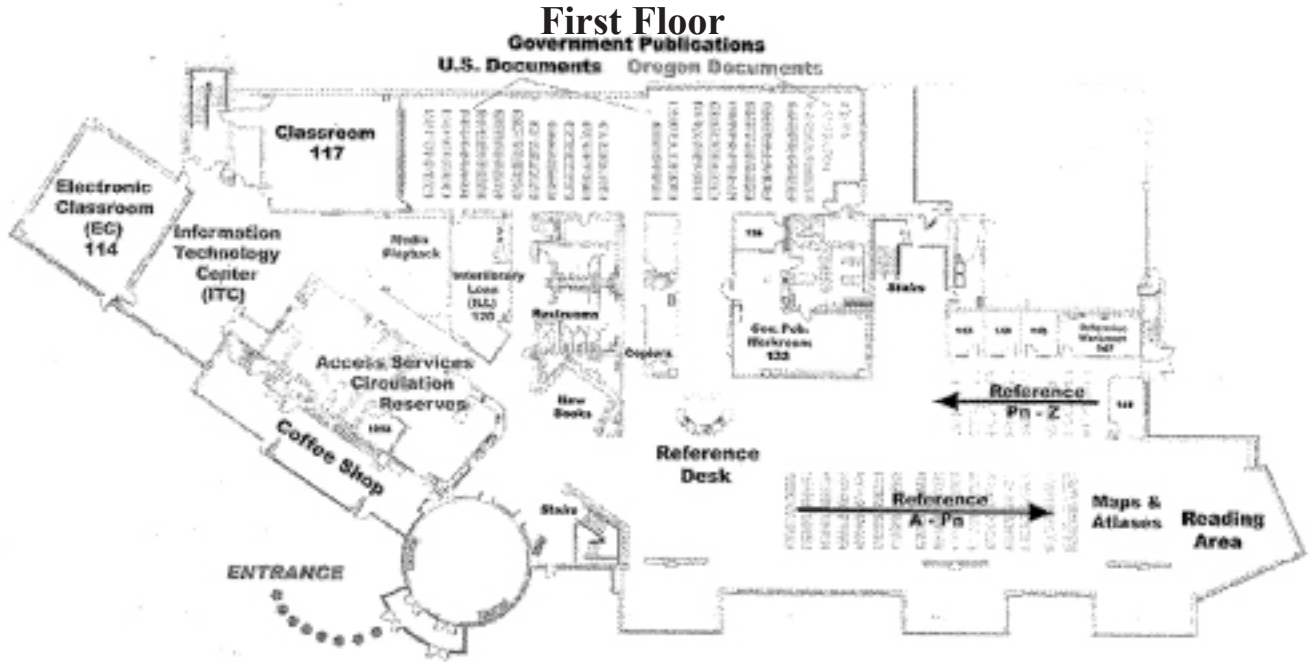

## Third Floor

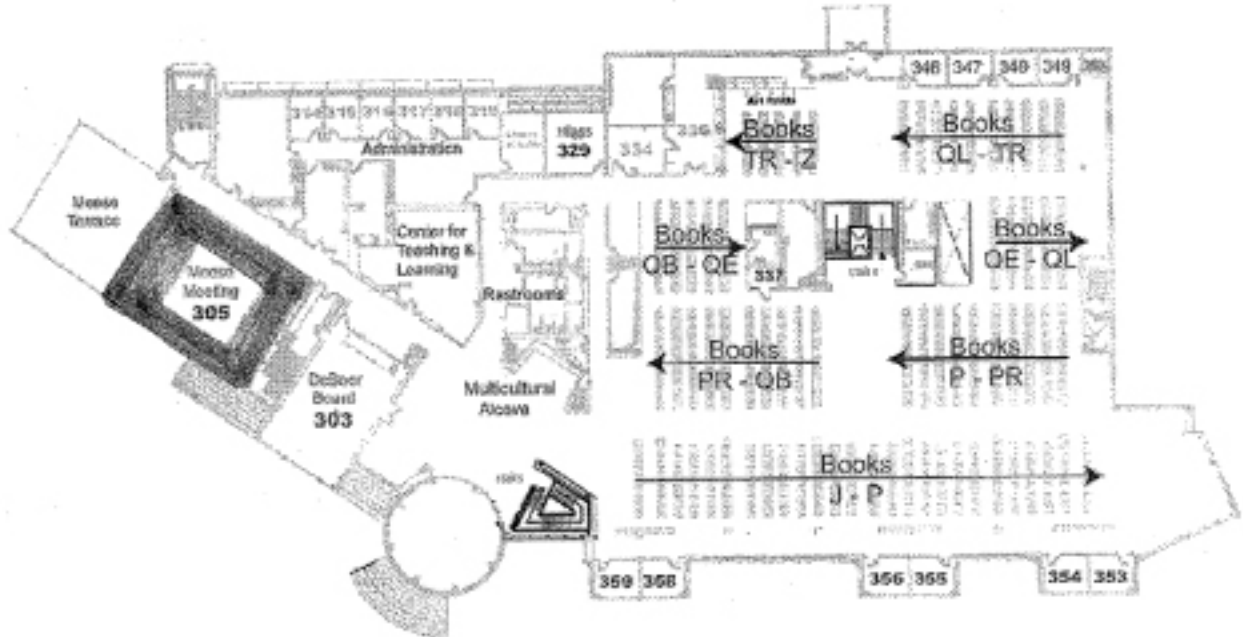

# Ashland City Map

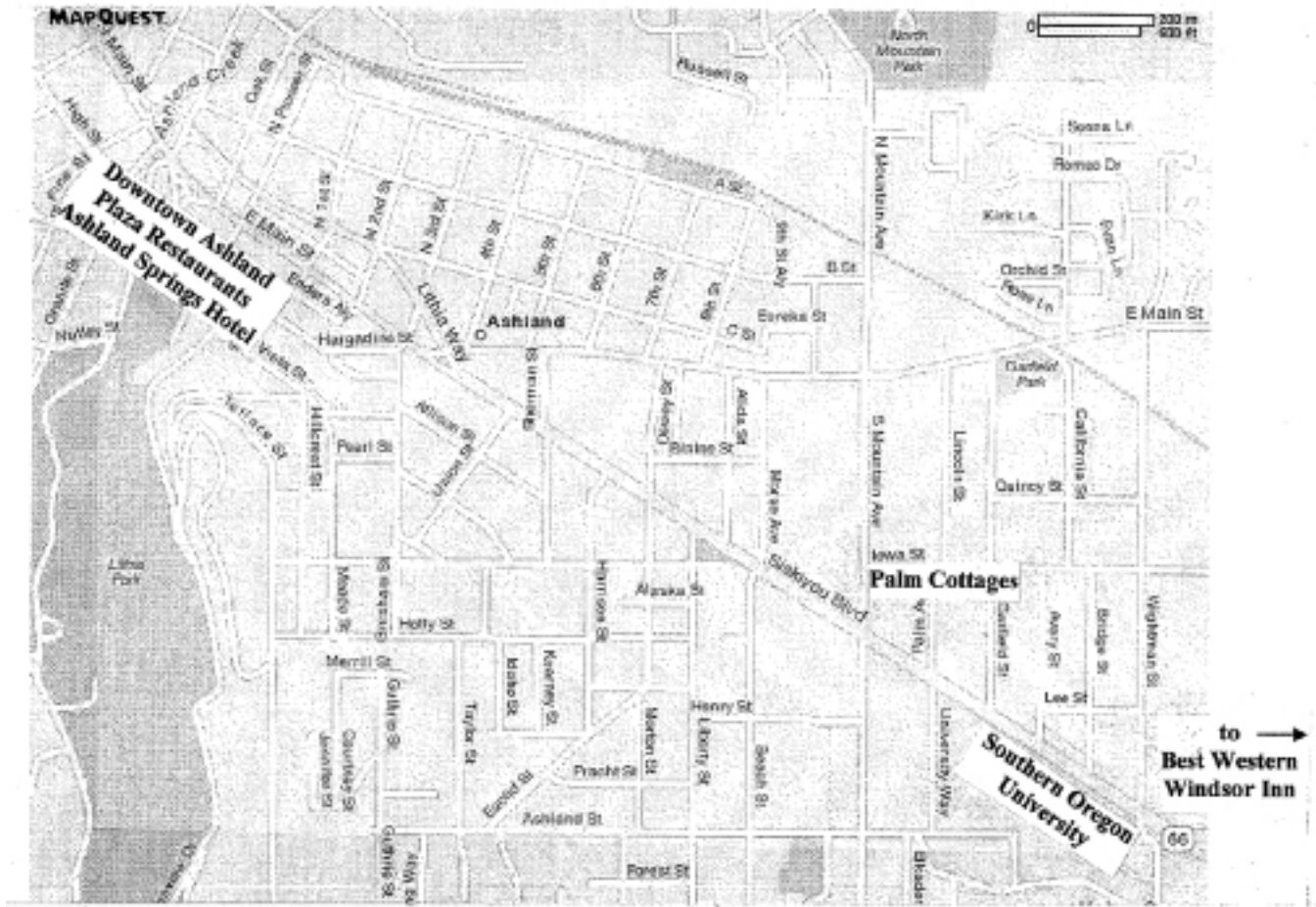

# Conference Evaluation Form

*34th Annual PCC Conference -Southern Oregon University*

Please help us to evaluate how successfully the aims of this year’s conference were achieved by completing this questionnaire, indicating how satisfied you were in each area (by circling the appropriate number, using the scale 1:5) or by writing in the boxes. The information you give on this form is confidential. It will be used by the conference organizers to measure the effectiveness of our conference and to share with conference organizers for next year.

How satisfied were you?

	Very satisfied » Very dissatisfied				
	☺		☹		☹
With the registration process and pre-event organization?	5	4	3	2	1
With the daily organization (conference information, timeliness of sessions, etc.)?	5	4	3	2	1
With the venue and facilities?	5	4	3	2	1
With the format of the presentations (combined papers with Q&A, Impressions of the Day, etc.)?	5	4	3	2	1
With the lodging and local travel arrangements?	5	4	3	2	1
With the relevance and interest of the sessions?	5	4	3	2	1
With the assistance with the presentations?	5	4	3	2	1
With the ancillary activities (reception, dinner, etc.)?	5	4	3	2	1
With the access at the venue (technical, physical or other)?	5	4	3	2	1

If you were not satisfied with any aspect (i.e. you rated 2 or 1 in the grid above), please indicate the reason:

*Please Turn Over For Additional Evaluation Questions*

What is your overall assessment of the conference? (Please circle appropriately)

Very good	5	4	3	2	1	Very Poor
-----------	---	---	---	---	---	-----------

Did the conference meet your expectations? (Please circle appropriately)

Yes	Partially	No	Not applicable
-----	-----------	----	----------------

Do you have any further comments or suggestions for next year's conference?

Thank you for taking the time to complete this evaluation form. Please detach this page from your program and drop the completed form in the Conference Evaluation Box at the conclusion of Friday's Closing Ceremony. If you wish to complete the evaluation form after the conference, an electronic copy and submission instructions will be available via the conference website at <http://www.sou.edu/pcc2010/>